

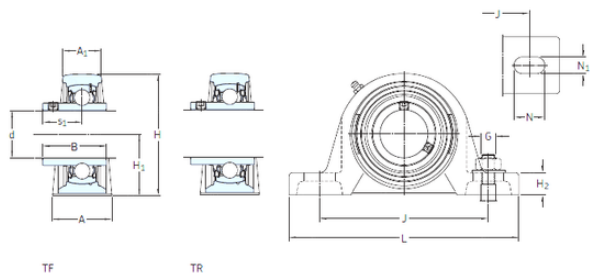

# BEARING CORP.OF AMERICA



## skf SY 20 WF Ball bearing plummer block units

Bearing No. SY 20 WF

SY 20 WF Bearing 2D drawings and 3D CAD models

Bore Diameter	20 mm
d	20 mm
s1	26,6 mm
A	32 mm
A1	21 mm
B1	43,7 mm
G	10 mm
H	65 mm
H1	33,3 mm
H2	14 mm
J	97 mm
L	127 mm
N	20,5 mm
N1	11,5 mm
Weight	0,62 Kg
Basic dynamic load rating (C)	12,7 kN
Basic static load rating (C0)	6,55 kN
Fatigue load limit (Pu)	0,28
Category	Mounted Units & Inserts
Inventory	0.0
Manufacturer Name	SKF
Minimum Buy Quantity	N/A
Weight / Kilogram	0.648
EAN	7316570953060
Product Group	M06110



## BEARING CORP.OF AMERICA

mounting:	Two-Bolt Base
radial dynamic load capacity:	12.7 kN
bore diameter:	20 mm
radial static load capacity:	6.55 kN
bore type:	Round
base width:	32 mm
base to bore centerline:	1.3110 in
bolt center-to-center length:	97 mm
housing material:	Cast Iron
maximum rpm:	8500 RPM
locking device:	Eccentric Collar
lubrication type:	Lubrication Fitting
expansion type:	Non-Expansion Bearing (Fixed)
series:	SY
overall length:	127 mm
replacement bearing:	YEL 204-2F
overall height:	65 mm
standards met:	ISO
finish/coating:	Uncoated
Housing material	Cast iron
A <sub>1</sub>	21 mm
A <sub>5</sub>	18.5 mm
B <sub>1</sub>	43.7 mm
H <sub>1</sub>	33.3 mm
H <sub>2</sub>	14 mm
J max.	106 mm
J min.	88 mm
N <sub>1</sub>	11.5 mm
s <sub>1</sub>	26.6 mm
R <sub>G</sub>	1/4-28 UNF
R <sub>1</sub>	2 mm



## BEARING CORP.OF AMERICA

R	45 °
$D_N$	6.5 mm
$SW_N$	7 mm
$G_N$	1/4-28 SAE-LT
$J_6$	118 mm
$J_7$	11.5 mm
$N_4$	2 mm
Basic dynamic load rating C	12.7 kN
Basic static load rating $C_0$	6.55 kN
Fatigue load limit $P_u$	0.28 kN
Limiting speed	8500 r/min
Mass bearing unit	0.6 kg
Thread grub screw $G_2$	M6x0.75
Hexagonal key size for grub screw N	3 mm
Recommended tightening torque for grub screw	4 N · m
Recommended diameter for attachment bolts, mm G	10 mm
Recommended diameter for attachment bolts, inch G	0.375 in