

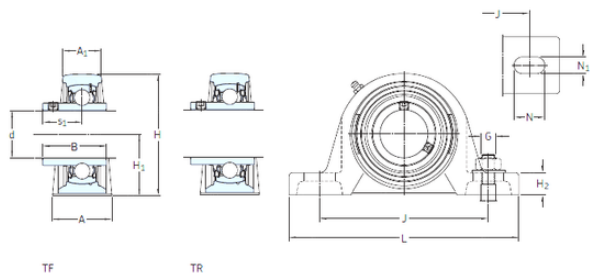

# BEARING CORP.OF AMERICA



## skf SYJ 1.1/2 TF Ball bearing plummer block units

Bearing No. SYJ 1.1/2 TF

SYJ 1.1/2 TF Bearing 2D drawings and 3D CAD models

Bore Diameter	38,1 mm
d	38,1 mm
s1	30,2 mm
A	49 mm
A1	31 mm
B	49,2 mm
G	14 mm
H	99 mm
H1	49,2 mm
H2	18 mm
J	136,5 mm
L	184 mm
N	25,5 mm
N1	17 mm
Weight	1,9 Kg
Basic dynamic load rating (C)	30,7 kN
Basic static load rating (C0)	19 kN
Fatigue load limit (Pu)	0,8
Housing material	Cast iron
A <sub>1</sub>	31 mm
B <sub>4</sub>	8 mm
H <sub>1</sub>	49.2 mm
H <sub>2</sub>	18 mm
J max.	145 mm
J min.	128 mm



## BEARING CORP.OF AMERICA

$N_1$	17 mm
$s_1$	30.2 mm
$R_G$	1/4-28 UNF
$R_1$	3.5 mm
R	45 °
$D_N$	6.5 mm
$SW_N$	7 mm
$G_N$	1/4-28 SAE-LT
$J_6$	170 mm
$J_7$	17.5 mm
$N_4$	4 mm
Basic dynamic load rating C	30.7 kN
Basic static load rating $C_0$	19 kN
Fatigue load limit $P_u$	0.8 kN
Limiting speed	4800 r/min
Mass bearing unit	1.85 kg
Thread grub screw $G_2$	5/16-24 UNF
Hexagonal key size for grub screw N	3.969 mm
Recommended tightening torque for grub screw	6.5 N · m
Recommended diameter for attachment bolts, mm G	14 mm
Recommended diameter for attachment bolts, inch G	0.5625 in