

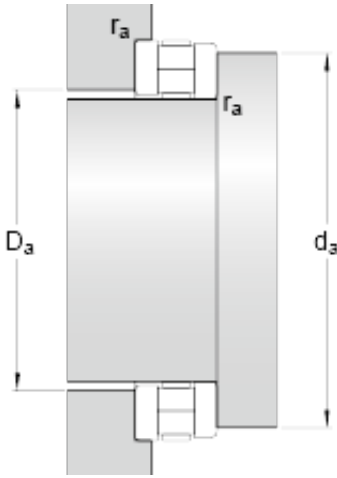

BEARING CORP.OF AMERICA



35 mm x 68 mm x 7 mm skf 89307 TN
Cylindrical roller thrust bearings

Bearing No. 89307 TN

d	35 mm
D	68 mm
H	20 mm
d ₁	68 mm
D ₁	37 mm
B	7 mm
r _{1,2} min.	1 mm
d _a min.	67 mm
D _a max.	38 mm
r _a max.	1 mm
Basic dynamic load rating C	62 kN
Basic static load rating C ₀	220 kN
Fatigue load limit P _u	22 kN
Reference speed	2400 r/min
Limiting speed	4800 r/min
Minimum axial load factor A	0.00387
Mass bearing	0.34 kg

89307 TN Bearing 2D drawings and 3D CAD models