

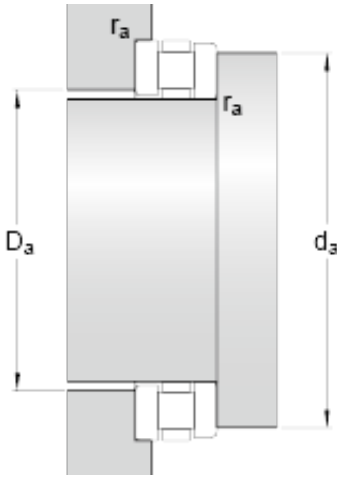

BEARING CORP.OF AMERICA



812/900 M Bearing 2D drawings and 3D CAD models

900 mm x 1180 mm x 65 mm skf 812/900 M
Cylindrical roller thrust bearings

Bearing No. 812/900 M

d	900 mm
D	1180 mm
H	220 mm
d ₁	1175 mm
D ₁	905 mm
B	65 mm
r _{1,2} min.	7.5 mm
d _a min.	1130 mm
D _a max.	950 mm
r _a max.	6 mm
Basic dynamic load rating C	8500 kN
Basic static load rating C ₀	49000 kN
Fatigue load limit P _u	2650 kN
Reference speed	100 r/min
Limiting speed	200 r/min
Minimum axial load factor A	190
Mass bearing	698 kg