

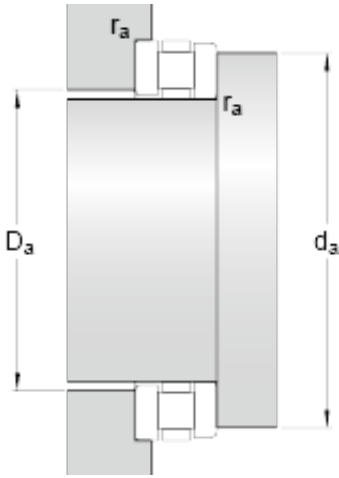

# BEARING CORP.OF AMERICA



440 mm x 600 mm x 39 mm skf 81288 M  
Cylindrical roller thrust bearings

Bearing No. 81288 M

d	440 mm
D	600 mm
H	130 mm
d <sub>1</sub>	595 mm
D <sub>1</sub>	445 mm
B	39 mm
r <sub>1,2</sub> min.	5 mm
d <sub>a</sub> min.	591 mm
D <sub>a</sub> max.	479 mm
r <sub>a</sub> max.	4 mm
Basic dynamic load rating C	2900 kN
Basic static load rating C <sub>0</sub>	14600 kN
Fatigue load limit P <sub>u</sub>	980 kN
Reference speed	220 r/min
Limiting speed	430 r/min
Minimum axial load factor A	17.053
Mass bearing	110 kg

81288 M Bearing 2D drawings and 3D CAD models