

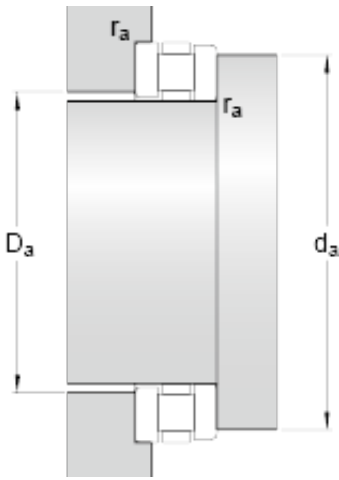

BEARING CORP.OF AMERICA



380 mm x 520 mm x 33.5 mm skf 81276 M
Cylindrical roller thrust bearings

Bearing No. 81276 M

d	380 mm
D	520 mm
H	112 mm
d ₁	515 mm
D ₁	385 mm
B	33.5 mm
r _{1,2} min.	4 mm
d _a min.	511 mm
D _a max.	413 mm
r _a max.	3 mm
Basic dynamic load rating C	2080 kN
Basic static load rating C ₀	10000 kN
Fatigue load limit P _u	720 kN
Reference speed	260 r/min
Limiting speed	500 r/min
Minimum axial load factor A	8
Mass bearing	75 kg

81276 M Bearing 2D drawings and 3D CAD models