

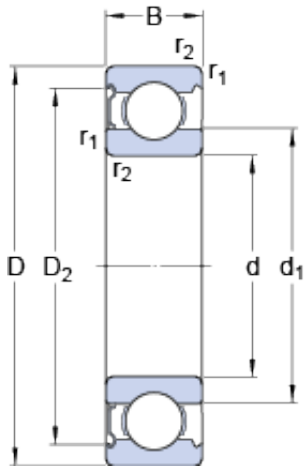

BEARING CORP.OF AMERICA



90 mm x 190 mm x 43 mm skf 6318-Z Deep groove ball bearings

Bearing No. 6318-Z

6318-Z Bearing 2D drawings and 3D CAD models

Size	190x90x43 mm
Bore Diameter	190 mm
Outer Diameter	90 mm
Width	43 mm
d	90 mm
D	190 mm
B	43 mm
d ₁	121.15 mm
D ₂	163.9 mm
r _{1,2} - min.	3 mm
d _a - min.	104 mm
d _a - max.	120.9 mm
D _a - max.	176 mm
r _a - max.	2.5 mm
Basic dynamic load rating - C	151 kN
Basic static load rating - C ₀	108 kN
Fatigue load limit - P _u	3.8 kN
Reference speed	7500 r/min
Limiting speed	4800 r/min
Calculation factor - k _r	0.03
Calculation factor - f ₀	13
Category	Single Row Ball Bearings
Inventory	0.0
Manufacturer Name	SKF



BEARING CORP.OF AMERICA

Minimum Buy Quantity	N/A
Weight / Kilogram	0
Product Group	B00308
Enclosure	1 Metal Shield
Precision Class	ABEC 1 ISO P0
Maximum Capacity / Filling Slot	No
Rolling Element	Ball Bearing
Snap Ring	No
Internal Special Features	No
Cage Material	Steel
Internal Clearance	C0-Medium
Inch - Metric	Metric
Long Description	90MM Bore; 190MM Outside Diameter; 43MM Outer Race Width; 1 Metal Shield; Ball Bearing; ABEC 1 ISO P0; No Filling Slot; No Snap Ring; No Internal Special Features; C0-Medium Internal Clearance; Stee
Other Features	Deep Groove
Category	Single Row Ball Bearing
UNSPSC	31171504
Harmonized Tariff Code	8482.10.50.68
Noun	Bearing
Keyword String	Ball
Manufacturer URL	http://www.skf.com
Manufacturer Item Number	6318-Z
Weight / LBS	11.1816
Bore	3.543 Inch 90 Millimeter
Outer Race Width	1.693 Inch 43 Millimeter
Inner Race Width	0 Inch 0 Millimeter
Outside Diameter	7.48 Inch 190 Millimeter



BEARING CORP.OF AMERICA

d_1	121.15 mm
D_2	163.9 mm
$r_{1,2}$ min.	3 mm
d_a min.	104 mm
d_a max.	120.9 mm
D_a max.	176 mm
r_a max.	2.5 mm
Basic dynamic load rating C	151 kN
Basic static load rating C_0	108 kN
Fatigue load limit P_u	3.8 kN
Calculation factor k_r	0.03
Calculation factor f_0	13.3
Mass bearing	5.01 kg