

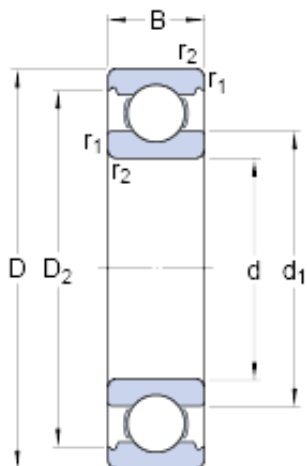

BEARING CORP.OF AMERICA



25 mm x 52 mm x 15 mm skf 6205 ETN9 Deep groove ball bearings

Bearing No. 6205 ETN9

6205 ETN9 Bearing 2D drawings and 3D CAD models

Size	52x25x15 mm
Bore Diameter	52 mm
Outer Diameter	25 mm
Width	15 mm
d	25 mm
D	52 mm
B	15 mm
d ₁	33.1 mm
D ₂	46.21 mm
r _{1,2} - min.	1 mm
d _a - min.	30.6 mm
D _a - max.	46.4 mm
r _a - max.	1 mm
Basic dynamic load rating - C	17.8 kN
Basic static load rating - C ₀	9.3 kN
Fatigue load limit - P _u	0.4 kN
Reference speed	28000 r/min
Limiting speed	18000 r/min
Calculation factor - k _r	0.025
Calculation factor - f ₀	13
Category	Single Row Ball Bearings
Inventory	0.0
Manufacturer Name	SKF
Minimum Buy Quantity	N/A



BEARING CORP.OF AMERICA

Weight / Kilogram	0.121
EAN	7316577740939
Product Group	B00308
Enclosure	Open
Precision Class	ABEC 1 ISO P0
Maximum Capacity / Filling Slot	No
Rolling Element	Ball Bearing
Snap Ring	No
Internal Special Features	No
Cage Material	Polyamide
Internal Clearance	C0-Medium
Inch - Metric	Metric
Long Description	25MM Bore; 52MM Outside Diameter; 15MM Outer Race Width; Open; Ball Bearing; ABEC 1 ISO P0; No Filling Slot; No Snap Ring; No Internal Special Features; C0-Medium Internal Clearance; Polyamide Cage
Other Features	Deep Groove Reinforced Ball Set
Category	Single Row Ball Bearing
UNSPSC	31171504
Harmonized Tariff Code	8482.10.50.68
Noun	Bearing
Keyword String	Ball
Manufacturer URL	http://www.skf.com
Manufacturer Item Number	6205 ETN9
Weight / LBS	0.28
Bore	0.984 Inch 25 Millimeter
Outside Diameter	2.047 Inch 52 Millimeter
Inner Race Width	0 Inch 0 Millimeter



BEARING CORP.OF AMERICA

Outer Race Width	0.591 Inch 15 Millimeter
bore diameter:	25 mm
static load capacity:	9.8 kN
outside diameter:	52 mm
precision rating:	Not Rated
overall width:	15 mm
finish/coating:	Uncoated
bore type:	Round
cage material:	Fiberglass Reinforced Nylon
closure type:	Open
outer ring width:	15 mm
row type & fill slot:	Single Row Non-Fill Slot
fillet radius:	1 mm
snap ring included:	Without Snap Ring
maximum rpm:	18000 RPM
internal clearance:	C0
series:	62
dynamic load capacity:	17.8 kN
d_1	33.1 mm
D_2	46.21 mm
d_a min.	30.6 mm
D_a max.	46.4 mm
r_a max.	1 mm
Basic dynamic load rating C	17.8 kN
Basic static load rating C_0	9.3 kN
Fatigue load limit P_u	0.4 kN
Calculation factor k_r	0.025
Calculation factor f_0	13
Mass bearing	0.12 kg